

Ref: 4

**PROPOSED BARE LAND STRATA OF LOT 11, SECTION 3, RANGE 8,
SOMENOS DISTRICT, PLAN 1883. EXCEPT PART IN PLAN 23078.**
CIVIC ADDRESS: 6409 WICKS ROAD, NORTH COWICHAN



The intended plot size of this plan is 432mm in width by 279mm in height (B-size) when plotted at a scale of 1:750.

All distances are in metres and decimals thereof, unless otherwise noted.

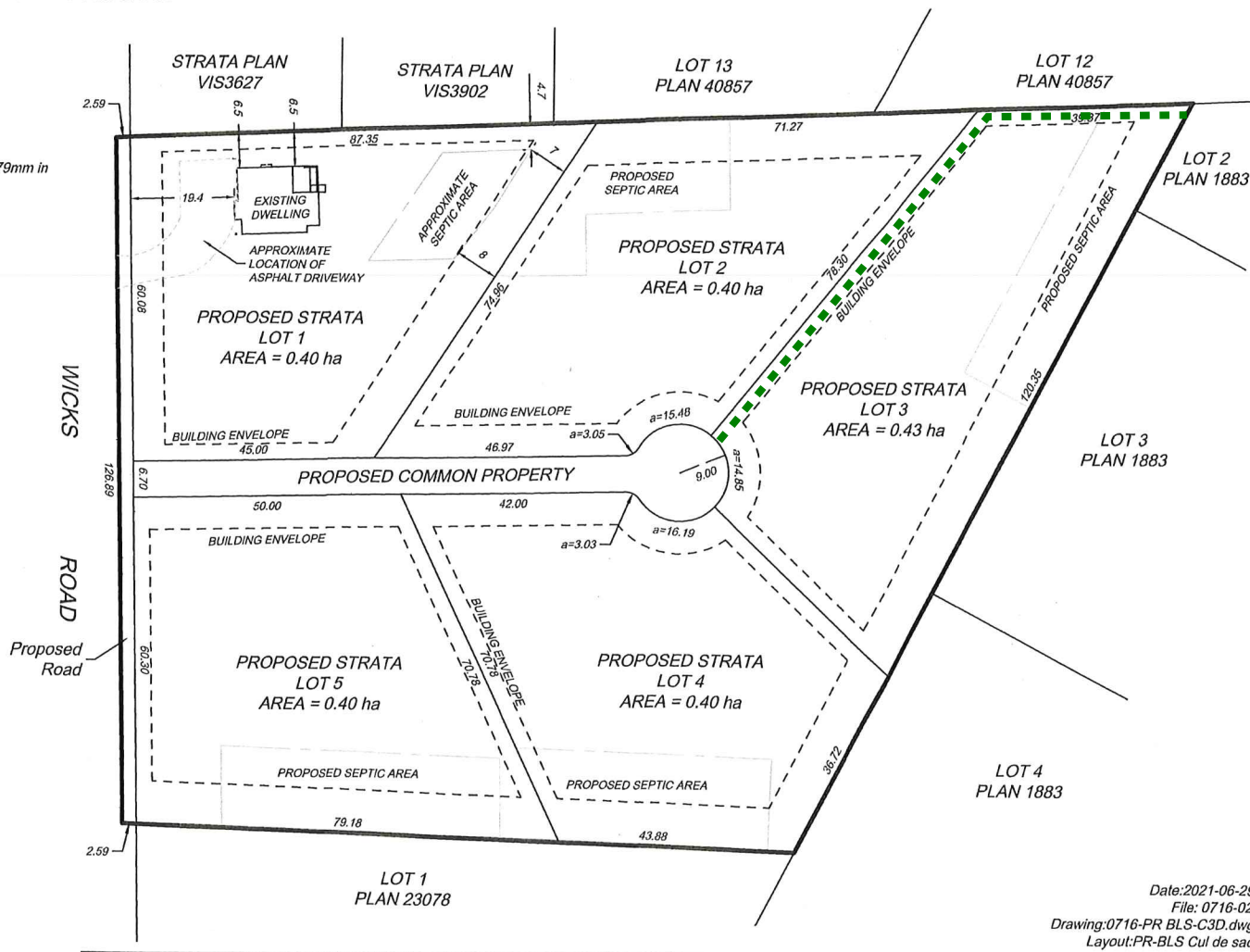
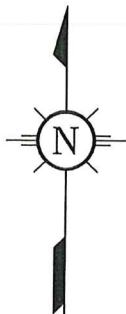

Date: 2021-06-29
File: 0716-02
Drawing: 0716-PR BLS-C3D.dwg
Layout: PR-BLS Cul de sac