

SKETCH FOR PROPOSED GARAGE ADDITION  
 LOT 72, SECTION 18, RANGE 5, CHEMAINUS DISTRICT, PLAN 303A

PID 006-143-750

Scale = 1: 200



The Intended plot size of this plan is 560 mm in width by 432 mm in height  
 (C size) when plotted at a scale of 1:200

LEGEND

Grid bearings are derived from observations  
 between geodetic control monuments 4421 and 78H8150.

△ denotes traverse hub spike set

All distances are in metres and decimals thereof.

Elevations are in metres derived from GCM 78H8150

Date of Field Surveys : Topo May 3 2022

Civic Address : 9928 Maple Street Chemainus BC

ZONING R3 RESIDENTIAL ONE AND TWO FAMILY

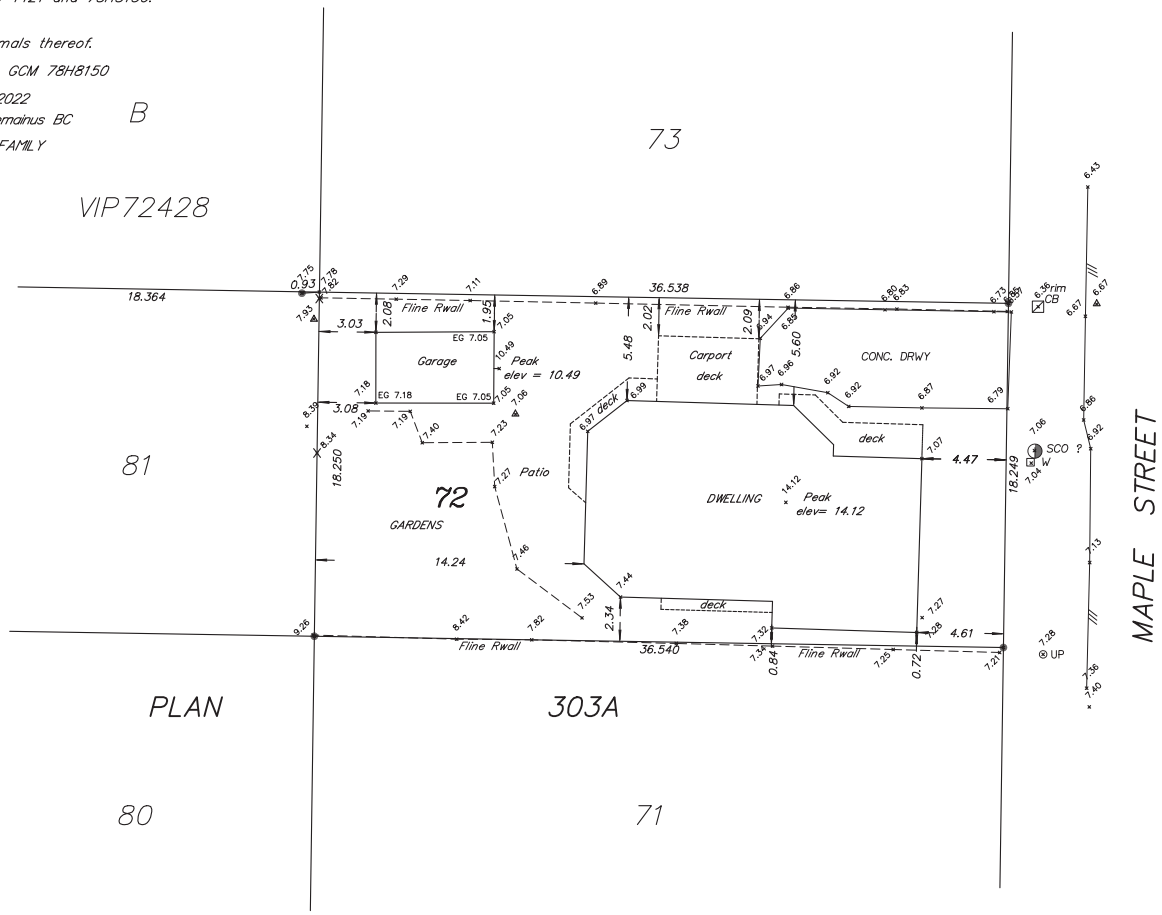

This document is not valid unless originally signed and sealed.  
 This plan is for Building Permit purposes and not  
 for the re-establishment of property boundaries.  
 This document has been prepared for the exclusive use of  
 Darcy Mattson and Gerald W. Lindberg, B.C.L.S. shall  
 not be responsible for the unauthorized distribution and/or  
 any use a third party makes of this document.  
 Certified correct this 27 th day of July, 2022

Gerald W. Lindberg B.C.L.S.

© G.W. Lindberg, 2022

All rights reserved. No person may copy, reproduce,  
 transmit or alter this document in whole or in part  
 without the consent of the signatory.

G.W. LINDBERG LAND SURVEYING INC.  
 Professional Land Surveyor  
 Surveying & Geomatics Services  
 9261 Chemainus Road Tel. (250) 246-9393  
 Chemainus, B.C. Email gw@lindberg@shaw.ca

PROJECT: SKETCH PLAN  
 CLIENT: Kay Porter & Darcy Mattson

Calcs by: GWL Date: July 26 2022 Drawing Number: GWL022-1270-SITE PLAN  
 Drawn by: GWL